

# G2, G4, G6, G8 GH2, GH4, GH6, GH8

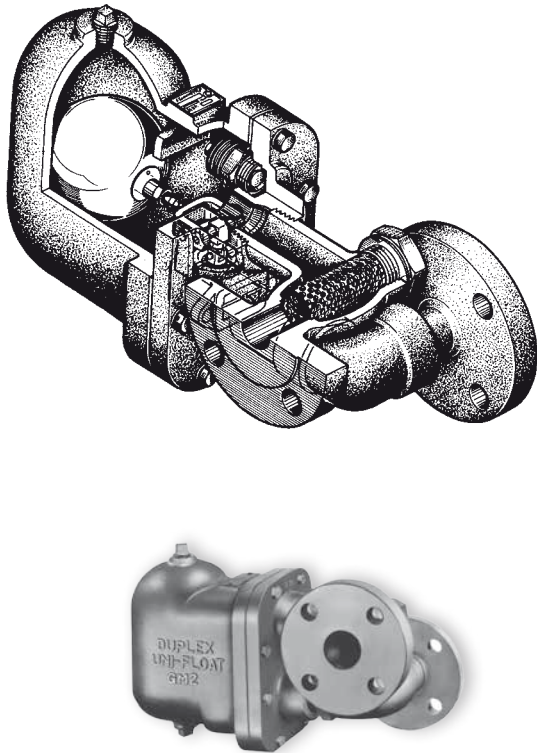

Capacity Chart

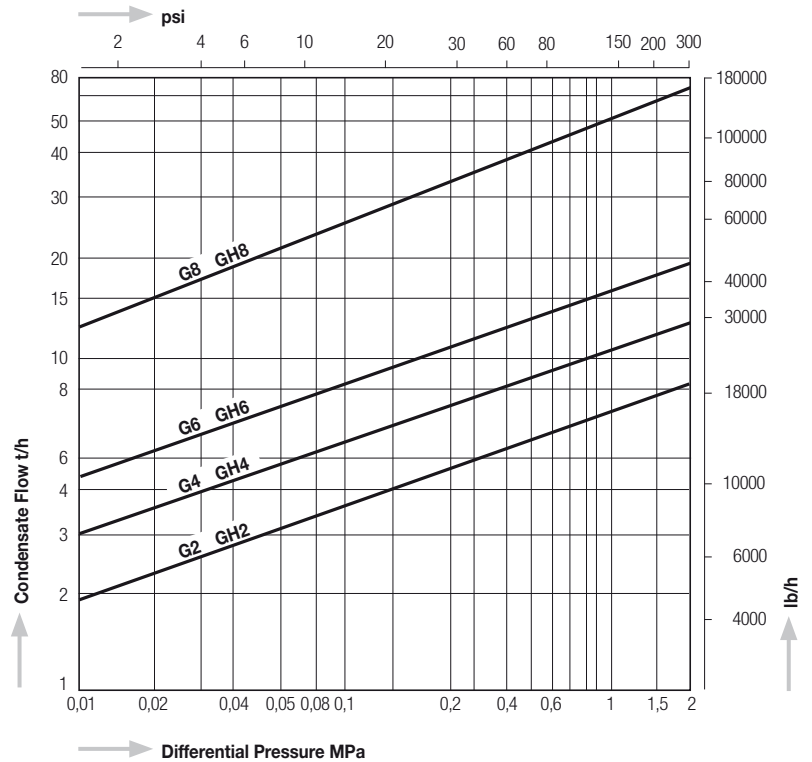

Dimensions

G2 / GH2

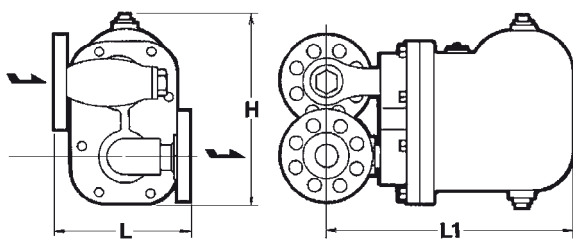

G4, G6, G8 / GH4, GH6, GH8

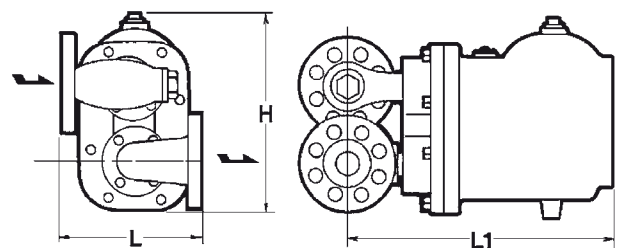

Model	Connections	Size (in)	Operating Pressure Range		Max. Operating Temperature		Dimensions (mm)			Dimensions (in)			Body Material	Weight	
			MPa	psig	°C	°F	L	L <sub>1</sub>	H	L	L <sub>1</sub>	H		kg	lb
G2	Flanged JIS, ASME, DIN	1"	0,01 - 1,6	1.5 - 230	220	428	175	310	250	6.9	12.2	9.8	Cast Iron FC250	22	48.4
		180					7.1								
		190					7.5								
		200					7.9								
G4	Flanged JIS, ASME, DIN	1 1/4" - 2"	0,01 - 2,0	1.5 - 290	400	752	200	380	320	7.9	14.9	12.6	Cast Steel SCPH2	45	99.0
270		10.6													
350		13.8													
350		13.8													
G6	Flanged JIS, ASME, DIN	1 1/2" - 3"	0,01 - 2,0	1.5 - 290	400	752	270	415	345	10.6	16.3	13.6	Cast Steel SCPH2	70	154.0
350		13.8													
415		16.3													
470		18.5													
G8	Flanged JIS, ASME, DIN	3", 4"	0,01 - 2,0	1.5 - 290	400	752	350	590	470	13.8	23.2	18.5	Cast Steel SCPH2	165	363.0
415		16.3													
470		18.5													
590		23.2													
GH2	Flanged JIS, ASME, DIN	1" - 1 1/2"	0,01 - 2,0	1.5 - 290	400	752	200	310	235	7.9	12.2	9.1	Cast Steel SCPH2	25	55.0
210		8.3													
200		7.9													
270		10.6													
GH4	Flanged JIS, ASME, DIN	1 1/4" - 2"	0,01 - 2,0	1.5 - 290	400	752	200	380	320	7.9	14.9	12.6	Cast Steel SCPH2	45	99.0
270		10.6													
350		13.8													
350		13.8													
GH6	Flanged JIS, ASME, DIN	1 1/2" - 3"	0,01 - 2,0	1.5 - 290	400	752	270	415	345	10.6	16.3	13.6	Cast Steel SCPH2	70	154.0
350		13.8													
415		16.3													
470		18.5													
GH8	Flanged JIS, ASME, DIN	3", 4"	0,01 - 2,0	1.5 - 290	400	752	350	590	470	13.8	23.2	18.5	Cast Steel SCPH2	165	363.0
415		16.3													
470		18.5													
590		23.2													