

Bimetal Temperature Control Trap – Higher Version **SERIES TB**

# TB51, TB52

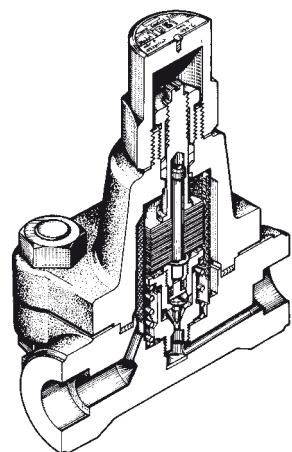

Basic Type

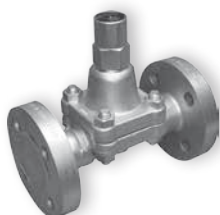

Flanged

Special face-to-face dimensions available.

\* **Curve 1** shows the trap's maximum capacity when discharging cold condensate at a temperature of 20°C (68°F).

\*\* **Curve 2** shows the trap's maximum capacity when discharging hot condensate at a temperature of 10°C (18°F) below the adjusted temperature of the trap.

**Standard factory setting:**

TB51-45, TB52-45:  
180°C at 2,1 MPa; 356°F at 290 psig

TB51-65, TB52-65:  
220°C at 4,4 MPa; 428°F at 630 psig

**The dashed line**

shows the standard factory setting.

Capacity Charts TB51-45, TB52-45

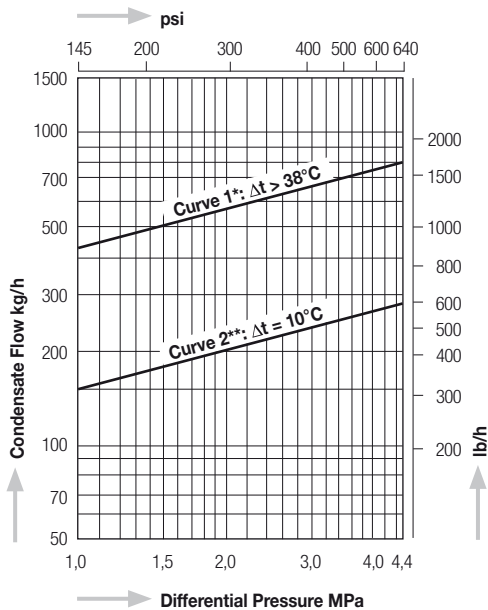

Capacity Charts TB51-65, TB52-65

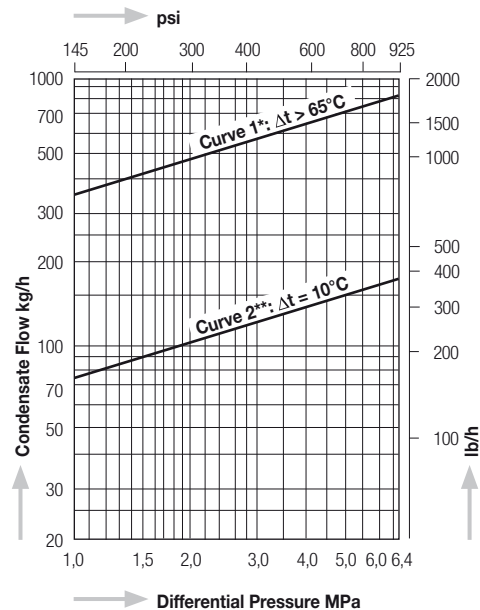

Temperature Stroke Charts TB51-45, TB52-45

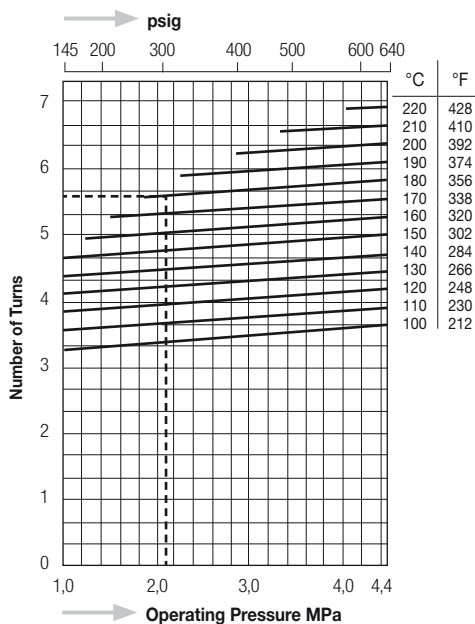

Temperature Stroke Charts TB51-65, TB52-65

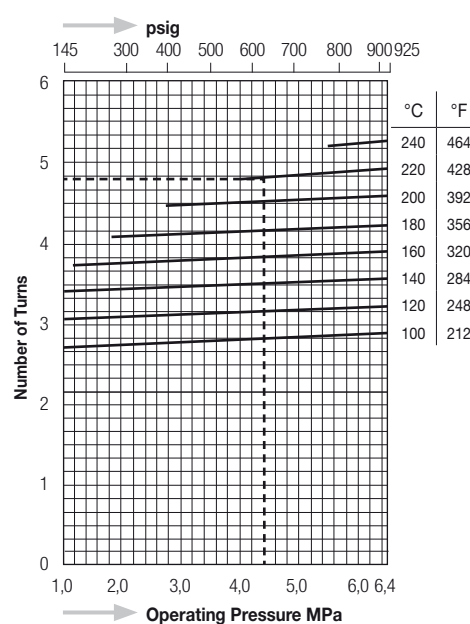

Dimensions TB51, TB52

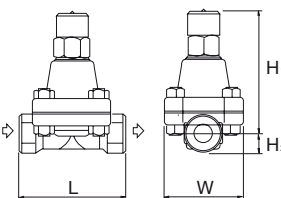

Dimensions TB51F, TB52F

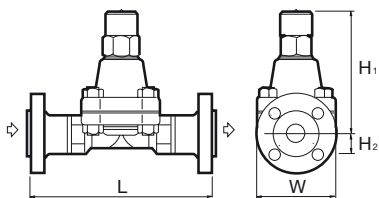

Table 1: Face-to-face dimensions / weights

Model	Size (in)	ASME 600 lb				DIN PN63 / PN100				JIS 63 K / ASME 900 lb			
		mm	in	kg	lb	mm	in	kg	lb	mm	in	kg	lb
TB51F TB52F	1/2"	200	7.9	8,8	19.4	210	8.3	8,8	19.4	220	8.7	9,0	19.4
	3/4"	210	8.3	10,2	22.4	230	9.1	10,2	22.4	230	9.1	10,2	22.4
	1"	240	9.4	11,2	24.6	230	9.1	11,0	23.3	240	9.4	11,2	24.6

Model	Connections	Size (in)	Max. Operating Pressure		Max. Operating Temperature		Adjustable Range		Dimensions (mm)				Dimensions (in)				Body Material	Weight		
			MPa	psig	°C	°F	°C	°F	L	H1	H2	W	L	H1	H2	W		kg	lb	
TB51 (TB52)	45 65	Screwed Rc, NPT	1/2" - 1"	4,4	640	425	800	100 - 220	212 - 428	130	156	25	100	5.1	6.1	1.0	3.9	Forged Steel A105	5,0	11.1
				6,4	925	(475)	(887)	100 - 240	212 - 464											
TB51 (TB52)W	45 65	Socket Weld JIS, ASME, DIN	1/2" - 1"	4,4	640	425	800	100 - 220	212 - 428	130	156	25	100	5.1	6.1	1.0	3.9		5,0	11.1
				6,4	925	(475)	(887)	100 - 240	212 - 464											
TB51 (TB52)F	45 65	Flanged JIS, ASME, DIN	1/2" - 1"	4,4	640	425	800	100 - 220	212 - 428	Table 1	156	25	100	Table 1	6.1	1.0	3.9	TB52: A182F22	Table 1	Table 1
				6,4	925	(475)	(887)	100 - 240	212 - 464											